

Pilot/Production Scale Roll Compactor System For Dry Granulation Processes

Maximum Processing Flexibility

Wide Production Capacity: 1 kg to 100 kg/hr

Optional Knife Mill Integrated on Front of Unit

Engineered Scalability

Constant Compaction Force within Roll Gap

Roll and Screw Design Scalable

to Production TFC Models

Unique Compaction Seal Design

Contained Compaction Zone

for Reducing the Amount of Fines

Inline De-aeration Design

Vertical Hopper and Screw De-Aerates

Product Prior to Compaction

Optional Vacuum De-Aeration Available

Color Touchscreen Control System

Roll Gap Measurement Display

Amp and Watt Displays for Roll and Screw

Validatable Process Control:

Hydraulic Roll Pressure

Roll and Screw Speeds

Quick Changeover Design

Cantilevered Rolls for Easy Cleaning

Portable Self-Contained System

Electrical and Compressed Air Connections



Shown with Optional Knife Mill

The TFC-520 is a self-contained and easy-to-operate roll compactor system built for dry granulation processes. The TFC-520 has a capacity of 1 kg to 100 kg/hr making it ideal for both pilot scale and production processes. No additional inserts are required at either end of the processing spectrum. With a unique vertical hopper and screw design, product is de-aerated prior to the compaction zone providing improved processing results. Engineered seals around the compaction zone greatly reduce unwanted fines. Designed as a portable and easily cleaned system, the TFC-520 is an ideal solution for any type of dry granulation process.

VECTOR CORPORATION

675 44th Street, Marion, IA 52302-3800

Phone: 319-377-8263 Fax: 319-377-5574

Email: vector.sales@vectorcorporation.com

www.vectorcorporation.com

TFC-520

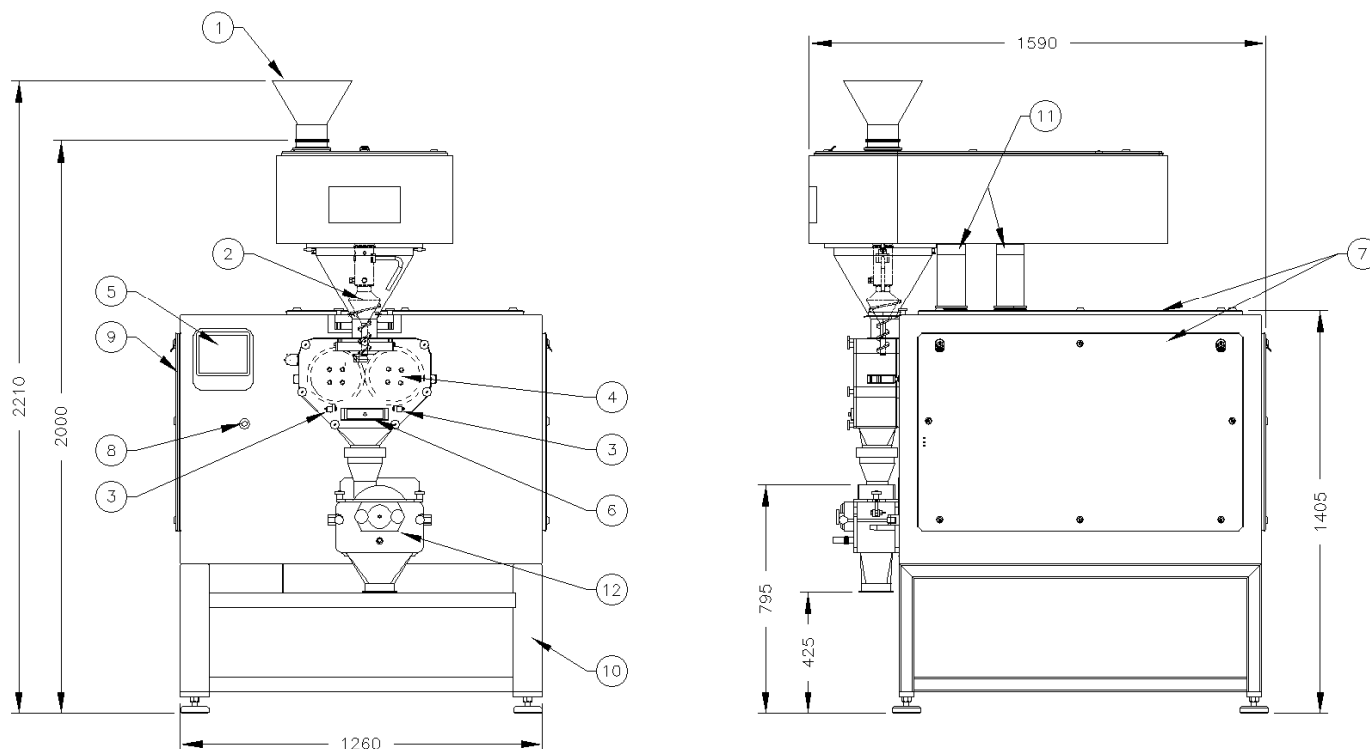

- | | |
|---|-------------------------|
| 1. Product Feed Hopper (Removable) | 7. Access Covers |
| 2. Screw Feeder | 8. Emergency Stop |
| 3. Roll Scraper | 9. Control Cabinet |
| 4. Rolls | 10. Support Base |
| 5. Color Touchscreen Operator Interface | 11. Lift Cylinder |
| 6. Product Sample Tray | 12. Optional Knife Mill |

NOTES:

- Dimensions are shown in millimeters.
- Dimensions shown are design dimensions and are subject to change due to manufacturer's tolerances.

TECHNICAL SPECIFICATIONS

Capacity Range: 1 kg – 100kg/hr	Compressed Air Supply: 60L/Min @ 6 Bar
Roll Speed: 3 – 24 RPM	Electrical Supply : 230 VAC, 60 Hz, 3 Phase
Maximum Roll Force: 130 kN	400 VAC, 50 Hz, 3 Phase
Roll Dimensions: 50mm x 200mm	Weight: 1000 kg (Approx.)
Screw Speed: 9-83 RPM	Design Standards: CE, UL, NFPA, CSA
Hopper Volume: 12 Liters	

Providing equipment and processing solutions around the world since 1972, Vector is a subsidiary of Freund Corporation located in Tokyo, Japan. Globally, the Freund/Vector team has thousands of system installations in the pharmaceutical, healthcare, chemical, agricultural, and food industries.